

# Bluewater 450M - Specification

## Probably the most important buying decision you will ever make!

**Yes, you can buy a house, a car or all manner of other assets, but how often does your life and the lives of your loved family and friends depend on that decision?**

When you choose to go ocean cruising, the answer is every day.

Bluewater Cruising Yachts are custom designed and made for each individual owner with one over-riding criterion, the safety and comfort of those sailing aboard her no matter what the conditions they encounter.

Only a Bluewater can give you that feeling of confidence the moment you step aboard one the first time – for many a Bluewater owner that was their first impression “wow, this feels safe and solid compared to other yachts”.

And that feedback continues for as long as they sail aboard a Bluewater.

Then there are all the additional comforts built-in, because we listen. Every Bluewater built has been better than the one before because each owner provides us with feedback. We have one of the largest water tankages available in a cruising yacht enabling you to travel further and longer. We have all the luxuries of home, a built-in laundry, a work bench, and easily accessible stowage for priority or emergency items. You don't have to bend over and dig to find what you need, it is there, just where you need it because we have listened to what experienced cruisers have told us.

And because not all cruising is done in tropical climates Bluewater yachts have natural ventilation, and the option of both heating and air conditioning so you can be comfortable no matter where you go.

You will think about so many factors when making your decision and there are so many choices available. Put yourself in the picture, think about what you really want and what is really important to you. If you truly want to experience the ultimate freedom of being able to go wherever you want, whenever you want, then your choice has to be the Safety and Comfort that only a Bluewater can guarantee.

Let us impress you with a test sail, and let us introduce you to other Bluewater owners because if we tell you, well that's just us saying so, but if you hear it direct from a current owner and experienced ocean cruiser then you will get the unbiased truth.

When you visit our website [www.bluewatercruisingyachts.com](http://www.bluewatercruisingyachts.com) you will find all the information and resources to help you make that decision. Make sure you download our booklet “Are You Serious about Ocean or Coastal Cruising – Things You Need To Know” and please do contact us with any questions you have, anytime.

**Speak directly with David Bradburn the owner of Bluewater Cruising Yachts.**

**You can contact David by email [david@bluewatercruisingyachts.com](mailto:david@bluewatercruisingyachts.com) or by calling 0412 656 271.**



# Bluewater 450M - Specification



## DIMENSIONS

LOA	45'1"	13.725m
LWL	40'0"	12.20m
Beam	13'5"	4.10m
Draft	6'5"	1.95m
Displacement	29,970lb	13,500kg
Ballast	10,434lb	4,700kg
Aux. Power	75hp	
Freeboard Fwd	4'5"	1.35m
Freeboard Aft	3'9"	1.15m
Water	242gal	1,100lt
Diesel	123gal	560lt
<b>Sail Area</b>		
No.2 Genoa	634sq.ft	59m <sup>2</sup>
Main	446sq.ft	41.5m <sup>2</sup>

## DESIGN DATA

Angle Vanishing Stability	129°+
Sail Area/Displacement Ratio	18.85
Displacement/Length Ratio	211
Ballast Ratio	35.7%

NB. All dimensions and measurements above are approximate only



# Bluewater 450M - Specification

## HULL

- 10 year warranty against osmosis
- Constructed in accordance with NSW Maritime survey requirements
- One piece solid GRP
- All exterior surfaces UV resistant isophthalic NPG gelcoat
- Tie layer Derekane SPV-1265 vinylester resin to guard against osmosis
- Collision reinforcing - Kevlar 300g forward main bulkhead
- Sub laminate - isophthalic polyester resin unwaxed
- Glass reinforcement ranges from:
  - Topsides 5117g GRP including 2 layers 601 biaxial
  - Forward main bulkhead 5416g GRP laminate including 300g Kevlar plus 12mm balsa core topside bow section
  - Bottom 7262g GRP laminate including 3 layers 601 biaxial
  - Centreline/Keel 11,600g laminate including 6 layers 601 biaxial

## DECK

- Laminate - 3920g GRP including 2 layers 601 biaxial either side of core
- Core Material:
  - 20mm PVC foam – foredeck, cabin top
  - 12mm foam – sidedecks
  - 18mm plywood – cockpit sole, winches
  - 3 layers 3mm coremat – under tracks & fittings

## RUDDER

- Balanced spade hung rudder
- Tapered 100mm 316 stainless shaft with 4 tangs fully glassed
- Delrin rudder bearing
- Emergency tiller and upper bearing
- 20mm ply gussets supporting rudder bearing glassed 2400g CSM

## HULL AND DECK JOIN

- Internal hull flange
- Bonded with glass reinforced filler 3600g CSM
- Goiot aluminium toerail bolted with fairleads

## BALLAST

- One piece 4% antimonial lead winged keel 4,760 kg
- Attached with 13 x 25mm 2205 stainless bolt to backing plates
- Bolted through heavily reinforced keel stub

## STRUCTURAL MEMBERS

- All longitudinal, thwartship members, bulkheads, cabin sole, chainplate knees and furniture are fibreglassed to the hull and deck creating an immensely strong honeycomb structure

## LONGITUDINALS

- Laminate - 3528g GRP utilising d/bias bias and unidirectional cloth reinforcing

## STRUCTURAL FLOORS

- Distribute keel loadings, strengthen hull, floor bearers
- Laminate - 5808g GRP utilising d/bias and unidirectional cloth reinforcing, approximately 13mm thickness

## MAST STEP

- Keel stepped mast
- GRP mast step supports compression loads
- Distributed over 2 thwartship members

## CABIN SOLE

- 18mm A-Bond plywood
- 6mm teak laid over
- Access to bilges throughout
- Positive locking inspection lids

## RIGGING ATTACHMENT

- Stainless chainplates through bolted
- Chainplate knees solid 8600g GRP utilising d/bias and unidirectional cloth reinforcing attached to longitudinals to distribute loadings
- Split backstay to bridle bolted through transom
- Forestay attached to bowfitting
- Inner forestay attached to collision bulkhead

## BULKHEADS

- Varnish grade A-Bond plywood 12-17mm
- Glass reinforcement - 2400g CSM
- Semi watertight main bulkhead

## FUEL TANK

- Capacity - approximately 560 lt in 4 tanks
- Location - aft cabin
- 2.5mm 316 s/s
- Inspection lids fitted
- Sufficient baffles fitted
- Inlet Ø 38mm
- Outlet Ø10mm
- Breather Ø 12mm
- Built to survey standard
- S/s bolts secure tanks in place

## WATER TANKS

- Capacity - approximately 1,100 lt
- Location - Integral tanks built within structural floors approximately 650 lt
- 2.5 mm 316 stainless tanks under seating approximately 450lt
- Integral tanks are lined with 4 coats of epoxy
- Sufficient baffles fitted
- Inspection lids fitted

## HOLDING TANK

- Acts as collision void
- Capacity - approximately 360lt
- Location - Under forward berth
- Toilet waste only with manual discharge overboard and pump out station



# Bluewater 450M - Specification

## ENGINE

- 4 cyl, freshwater cooled, 75 hp Yanmar direct drive 2.63:1 with deluxe instrument panel
- 80 amp alternator
- Engine beds:
  - Seasoned hardwood
  - Glass reinforcement - 2,400 CSM
- Shaft: 316 s/s  
38mm Ø  
Keyways fore and aft
- Bronze propeller skeg laminated 4,200g CSM
- 20" x 14" 3 blade bronze fixed prop
- Polyflex flexible coupling
- PSS shaft seal
- Bronze ball valves used throughout
- Flexible exhaust hose to outlet
- Exhaust highriser fitted
- GRP waterlock
- Bronze raw water inlet filter
- Control mechanism (forward, neutral, reverse) pedestal mounted
- Racor fuel filter
- Instrument panel positioned in cockpit
- Continuous, rated engine exhaust fan
- Acoustic insulation ss lined

## STEERING

- Edson CD-I Drag Link System
- Engine controls mounted to side, poly folding table, poly mug holder, instrument housing, high grab bar
- 48" wheel

## PLUMBING AND FIXTURES

- Through hull fittings all bronze with double s/s hose clamps
- 12-19mm Ø PVC hose for freshwater system
- 38mm Ø tank inlet/head outlet
- Filter in line from s/s freshwater tank to manual galley pump
- Separate shower sumps fitted with electric Whale Gulper pumps
- Johnson pressurised freshwater system with Whale footpump for backup
- 1 Whale Gusher 140lt min double action manual bilge pump
- 1 Johnson L2200 120lt min and L1600 100lt min 12v electric bilge pumps
- Johnson salt and fresh water deck wash with auto reel
- Hot and cold swim platform shower
- Engine/240v 50lt hot water system

## FRIDGE AND FREEZER

- SS lined 120 lt fridge front opening 12/240v utectic system
- SS lined 100 lt freezer top opening 12/240v utectic system
- SS dividers and shelves fitted

## ELECTRICS

- 12v electrical supply
- Geltec batteries:
  - 1 engine starting 100 AH
  - 6 x DC225-6 Gel batteries domestic supply 675 amp hr house capacity
- Electrical Control Panel:
  - Volt and amp meters
  - 25 x 12v DC circuit breakers and switches
- Engraved nav light panel
- Auto bilge pump switching
- 2 x 240v AC breakers and switches
- 8 off VDO fuel and water tank gauges
- 1 off holding tank gauge
- Navigation lights
- 12v lighting – Forcato cabin and bunk lights
- 3 x 12v outlets
- ICOM VHF Radio
- Shore Power - 3 outlets
- Autohelm ST60 Speed, Depth, Wind, cockpit mounted

## ACCOMMODATION

Interior design to feature framed cupboard doors with radius corner posts. Drawers fitted on runners.

The yacht's interior is built primarily from either cherry or oak, and faced plywood with matching veneers. All joinery is constructed in accordance with the best yacht practices with visible fastenings reduced to a minimum. Ventilation is provided where necessary.

## UPHOLSTERY

All settee and berth upholstery supplied. Covered in fabric to owner's choice from standard range. Custom made saloon seating with lumbar support uses hard and soft foam for added comfort.



# Bluewater 450M - Specification

## FITOUT MATERIALS

- Bulkheads – veneered plywood
- Joinery – solid timber, veneers
- Cabin sole – 6mm solid teak finished with high gloss varnish
- Toilet - moulded fibreglass
- Cabin Hull Lining – timber slats, vinyl panelling
- Saloon Hull Lining – timber slats, vinyl panelling
- Headliner – leather finish vinyl panelling with timber cover battens
- Hanging lockers – everdured and flowcoated
- Cabin Side Liner - leather finish vinyl panelling
- Galley Bench Top – corian
- Satin finish varnish
- Lockers – flowcoated, epoxied
- Latches – silver anodised pushbutton type
- Door Handles – silver anodised
- Stormboard – 10mm acrylic

### Forward Cabin

Double berth, holding tank under, hanging locker, 6 overhead lockers.

### Forward Port Head

Includes vanity with overhead cupboards and built in mirrors, Jabsco electric toilet with built in cover, teak grate, chrome flickmixer tap and shower handle, moulded sink, corian counter top, mylar shower curtain on anodised track.

### Forward Single Berth Cabin

Upper and lower bunks, top bunk swings down to form settee, tool storage under lower bunk, vice bolts to top bunk.

### Port Dinnette

U-shaped, lockers underneath and behind, removable chainplate knee covers, bookshelf with rail, fixed height (mirror finished) table with 12 bottle wine storage under.

### Starboard Lounge

Twin arm chairs with small table between, bookshelf with rail, liquor cabinet has built in bottle and glass storage, removable chainplate knee covers.

### Galley

features flush fitting toekicks, drawers on runners, top opening fridge/freezer, corian bench top, Broadwater LPG 2 burner stove, oven and griller with electronic ignition, twin deep bowl stainless steel sinks, microwave oven, manual freshwater footpump, stove cover, pot and pan storage, built in plate stowage, netted pantry in port aft cabin hanging locker.

### Navigation Station

½ chart size, piano hinged lid, circuit board, electronics, radios beside chart table, bookshelf, tank gauges, 2 filing cabinet drawers, batteries underneath, 2 seater bench seat with backrest.

### Aft Starboard Head

Includes vanity with overhead cupboards and built in mirrors, Jabsco electric toilet with built in cover, teak grate, chrome flickmixer tap, separate shower tap and head, moulded sink, corian counter top, mylar shower curtain on anodised track.

### Aft Cabin

Queen size island bed, hanging cupboards, twin corner seating, small bureau with mirror, 6 large storage lockers, bookshelves, abundant counter space, ensuite access, access to fuel tanks, access to aft machinery/steering compartment.



# Bluewater 450M - Specification

## DECK FITTINGS

- Flush fitting flexiteek decking, main deck, cockpit, transom
- Edson CDI draglink wheel steering incorporates engine controls, drink holder, and swing up table
- Plastimo 130 Compass with built in cover
- Pulpit with walk thru step/seat
- Pushpit with seat
- 6 tapered stanchions 750 mm high with 3 x 5 mm 316 lifelines
- 2 side access gates with swing down ladders
- Twin roller bow fitting to hinge for self launching
- Harken Deck Gear:
  - 2 x 3.5m adjustable genoa tracks with cars
  - Adjustable mainsheet traveller
  - Double genoa turning blocks
  - Ball bearing blocks
- Spinlock XCS 2 x 5 bank jammers
- Stainless steel flush fitting cabin top handrails
- Anodised Gebo flushline hatches: 7 off
  - 510 x 510 2 off
  - 275 x 275 5 off
- Anodised Gebo portlights: 12 off
  - 600 x 175 4 off
  - 375 x 175 4 off
  - 268 x 141 4 off
- Gebo hull ports: 2 off
  - 483 x 229 2 off

## DECK FITTINGS

- Andersen stainless steel winches: 7 off
  - 58 ST Primaries 2 off
  - 40 ST Secondaries 2 off
  - 46 ST Cabin Top (halyard) 2 off
  - 40 ST Mast 1 off
- Winch handles and pockets
- 316 ss fuel, water and waste deck fillers
- Recessed transom ladder with GRP cover
- Deck lockers include:
  - Windlass/chain locker
  - Forward sail locker
  - 2 large cockpit locker
  - 2 helm seat lockers
  - 2 transom lockers
  - 2 halyard rope lockers
  - 1 helm locker
- Lewmar H3 1000w heavy duty horizontal windlass fitted below deck with remote switching in cockpit plus chain counter
- 4 off 12" 316 ss mooring cleats
- 2 off 10" 316 ss pop up mooring cleats with drain
- Goiot anodised toerail fitted with fairleads
- Cockpit harness points fitted
- Transom shower fitted
- GRP sliding companionway hatch with perspex stormboard
- 60lb Manson plough anchor with 70m 3/8" galvanised chain
- 2 x 6.5 kg ss gas bottles
- Under cover halyards run along cabin top through diverters
- Fold down jackstay points fitted on deck

## MAINSHEET TARGA

- GRP cored targa utilising d/bias and unidirectional reinforcing with bimini garage
- 50mm mainsheet targa arch through bolted
- Targa light
- Vinyl/clear dodger with centre opening panel painted in Awlcraft metallic silver

## MAST AND RIGGING

- Keel stepped 1M 26 (252 x 162 6005AT5) section
- Upper section tapered
- Silver anodised
- Boom 250 x 140 single line reefing 2 reefs
- 316 1 x 19 ss rigging:
  - Forestay 10mm
  - Removable inner forestay 10mm
  - Backstay 8mm
  - Capshroud 11mm
  - Intermediate 10mm
  - Lower Shroud 12mm
- Spectra halyards.
- 2 spreader deck lights.
- Foredeck light

## HOOD SAILS

- 1 fully battened radial cut Mainsail with 3 reefs
- 120% radial cut furling genoa with suncover

## HULL PREPARATION

- 2 coats International HT9000 epoxy resin
- 3 coats International Interprotect epoxy primer
- 3 coats International antifouling
- Polyurethane sprayed lines
- Hull and deck is polished and finished with 3M water resistant wax



# Bluewater 450M - Specification

## STANDARD PRICE

---

**\$1,065,000.00 plus GST**

1 July 2013

## NOTES

---

- Dimension and sketches shown are approximate only and may include optional equipment. Please enquire further for optional equipment prices and specifications
- Bluewater Cruising Yachts Pty Ltd reserves the right to change plans, specifications, materials and suppliers without notice
- Prices quoted are exclusive of the GST and are ex factory

## WARRANTY

---

- 10 year structural guarantee



# Bluewater 450M - Specification

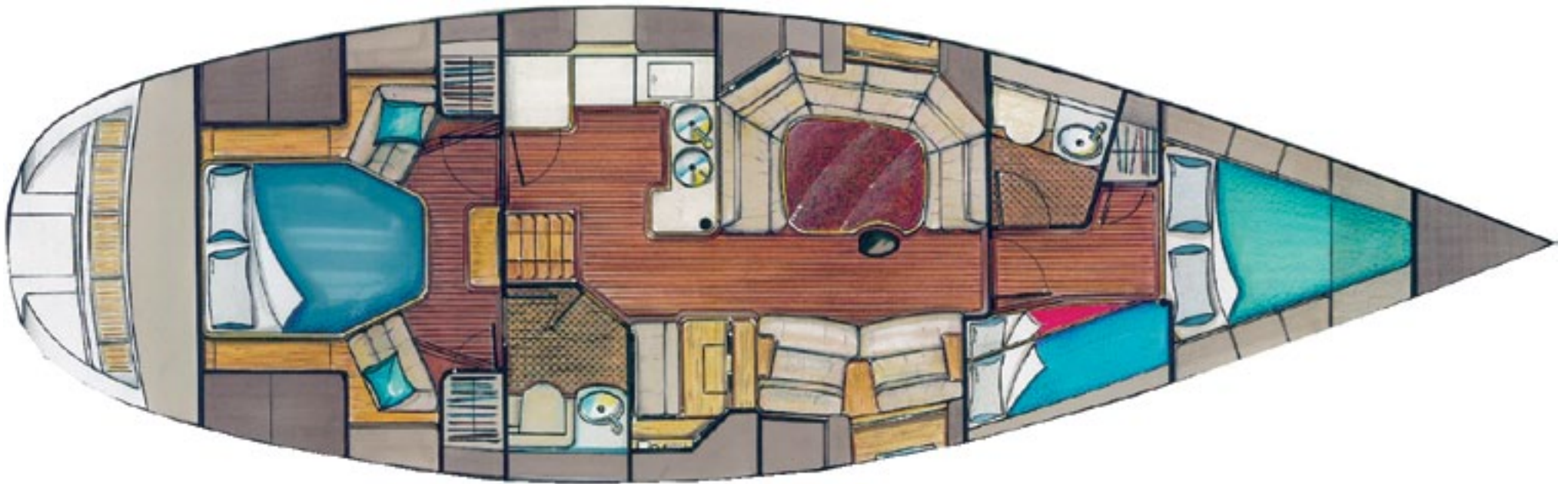

Standard Layout





# Bluewater 450M - Specification

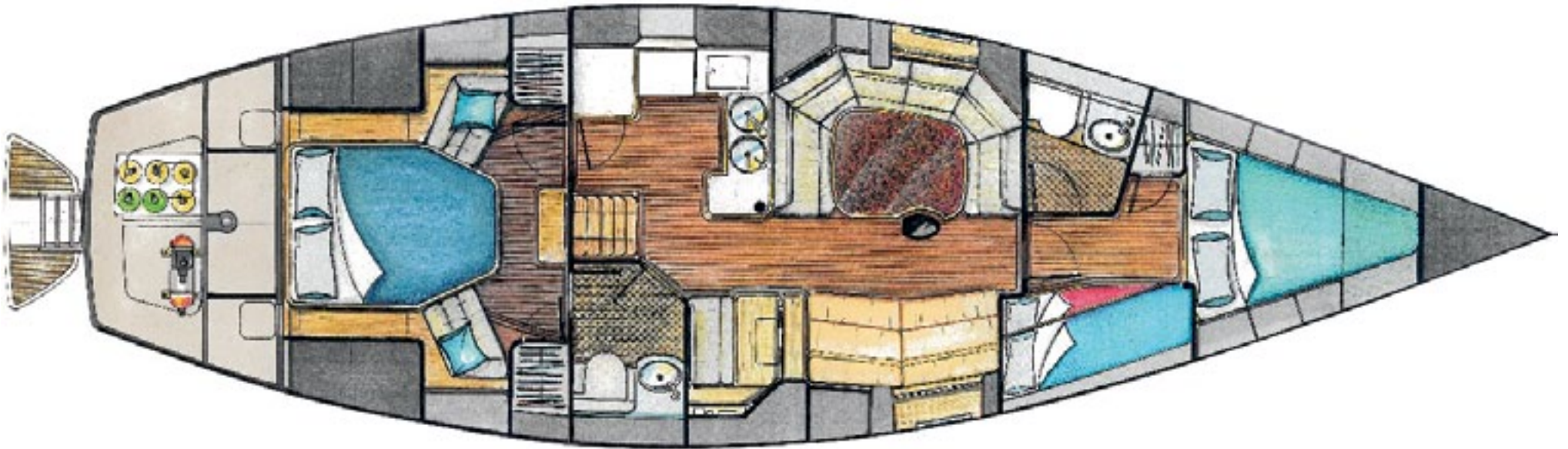

Hydraulic Operated Landing Platform

